

10

Hollow Shapes

Design essentials
featuring stylish
details. Perfect choice
for adaptable, modest
lighting solutions.



Straight
STR

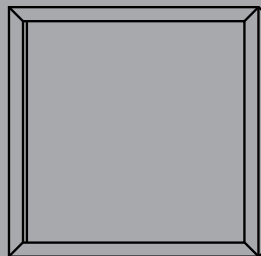

Square
SQ



Rectangle
RT

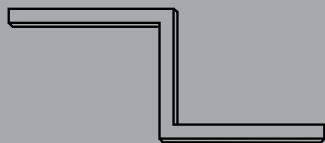

Z - Left

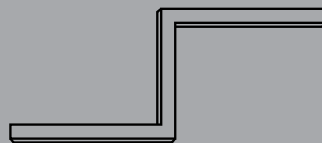

Z - Right

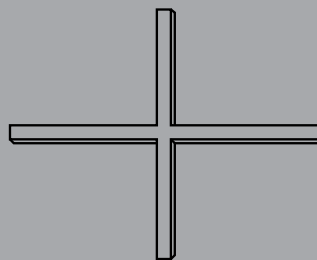

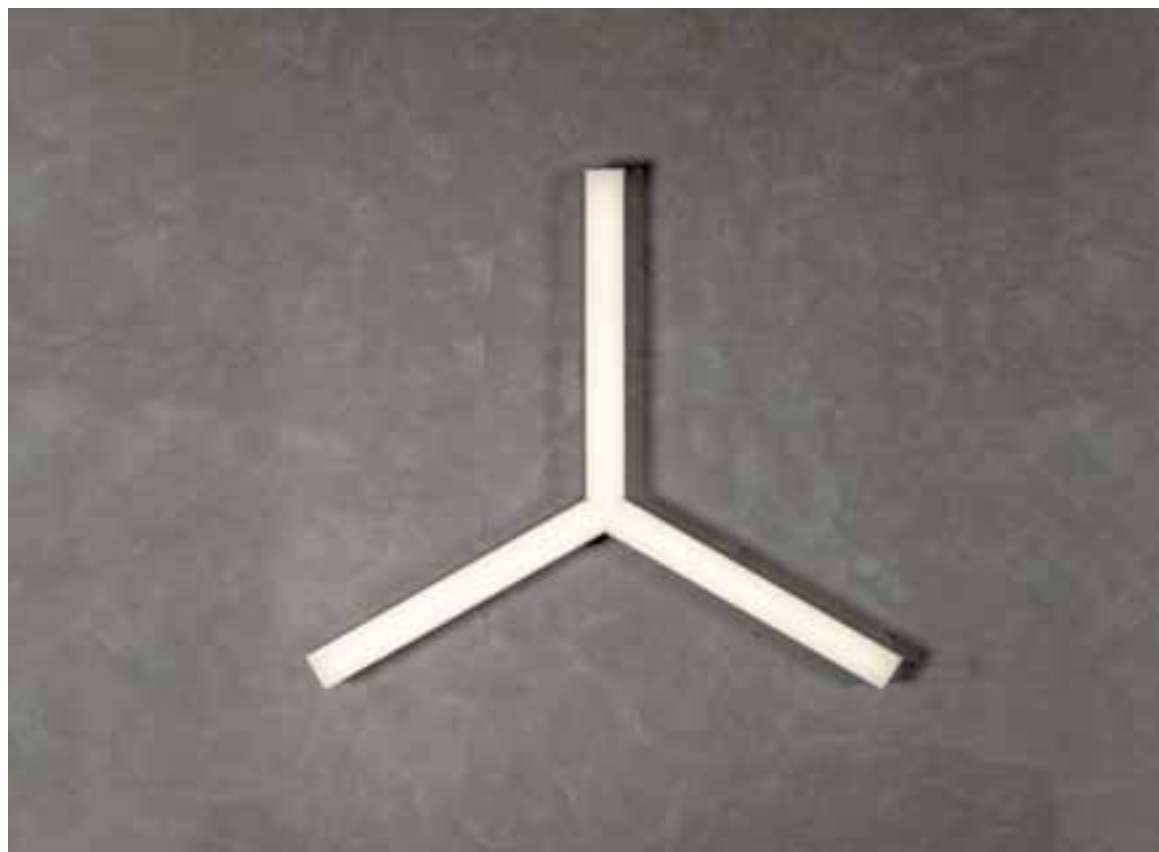
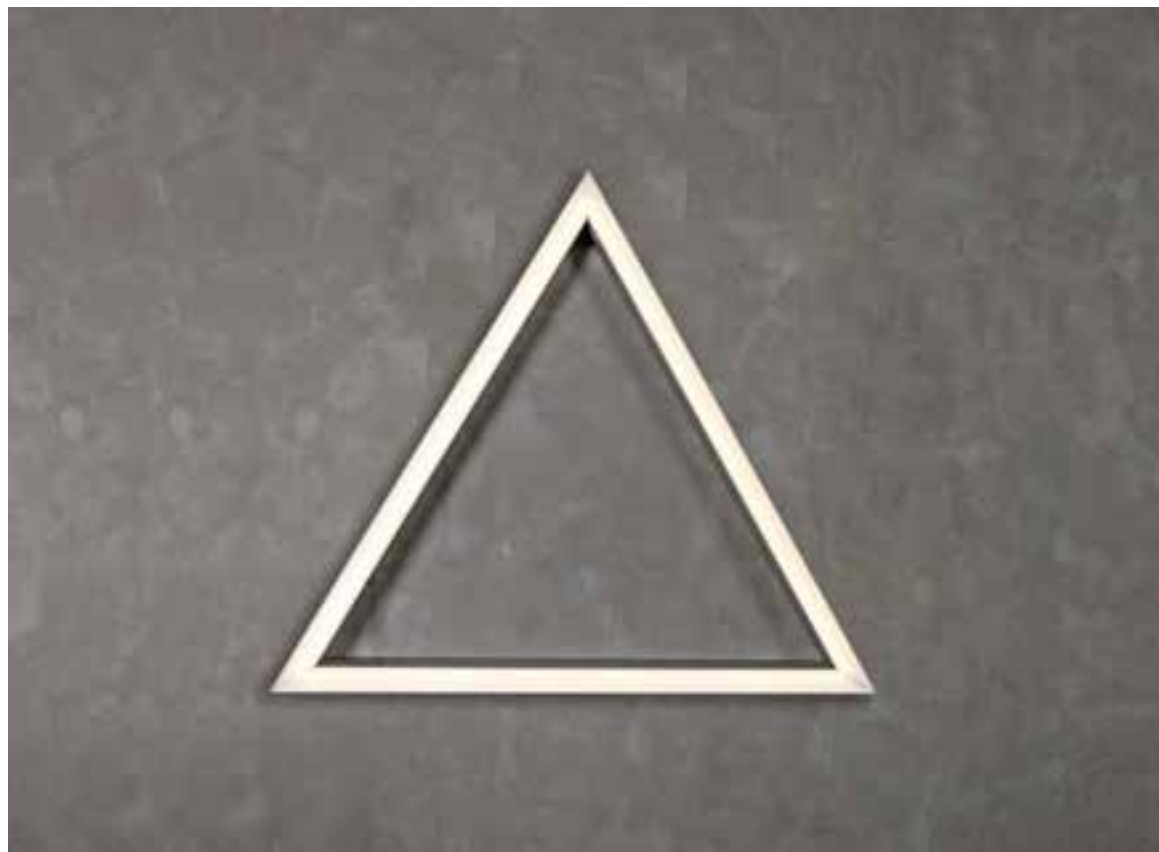
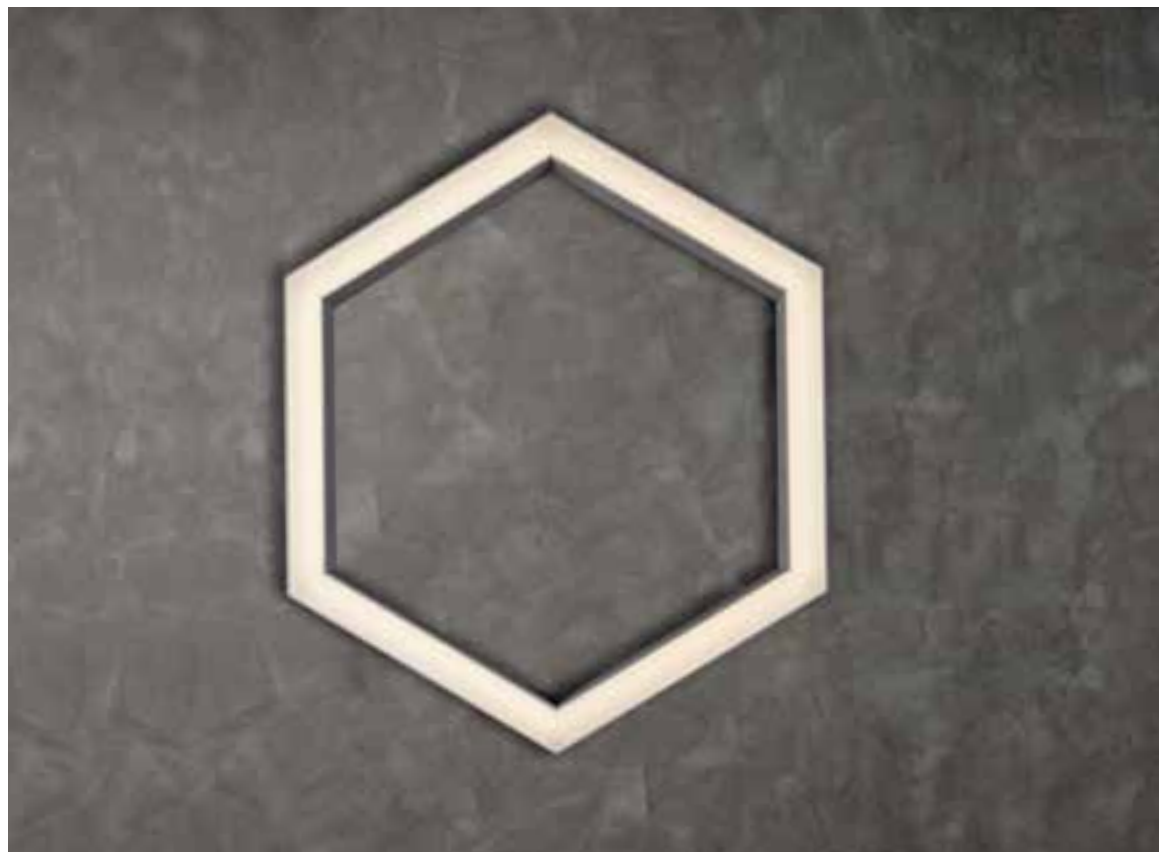

X

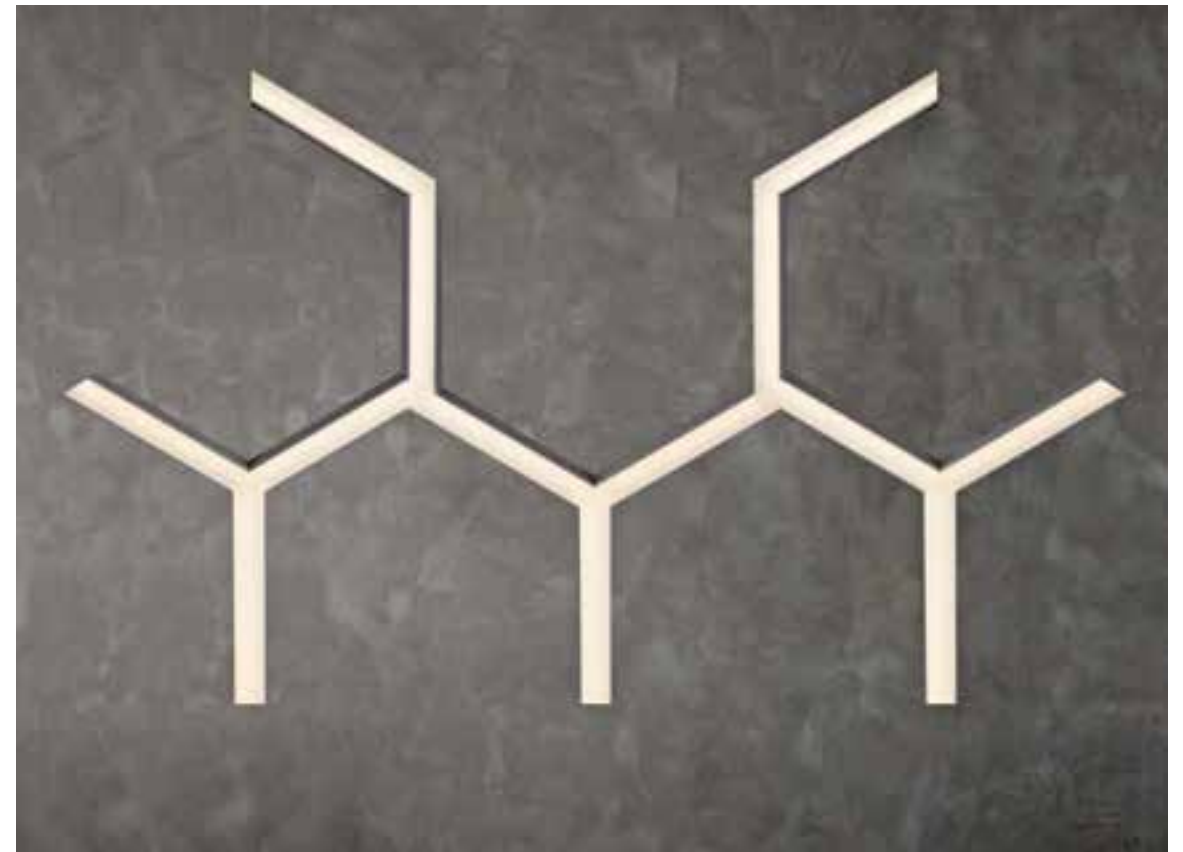
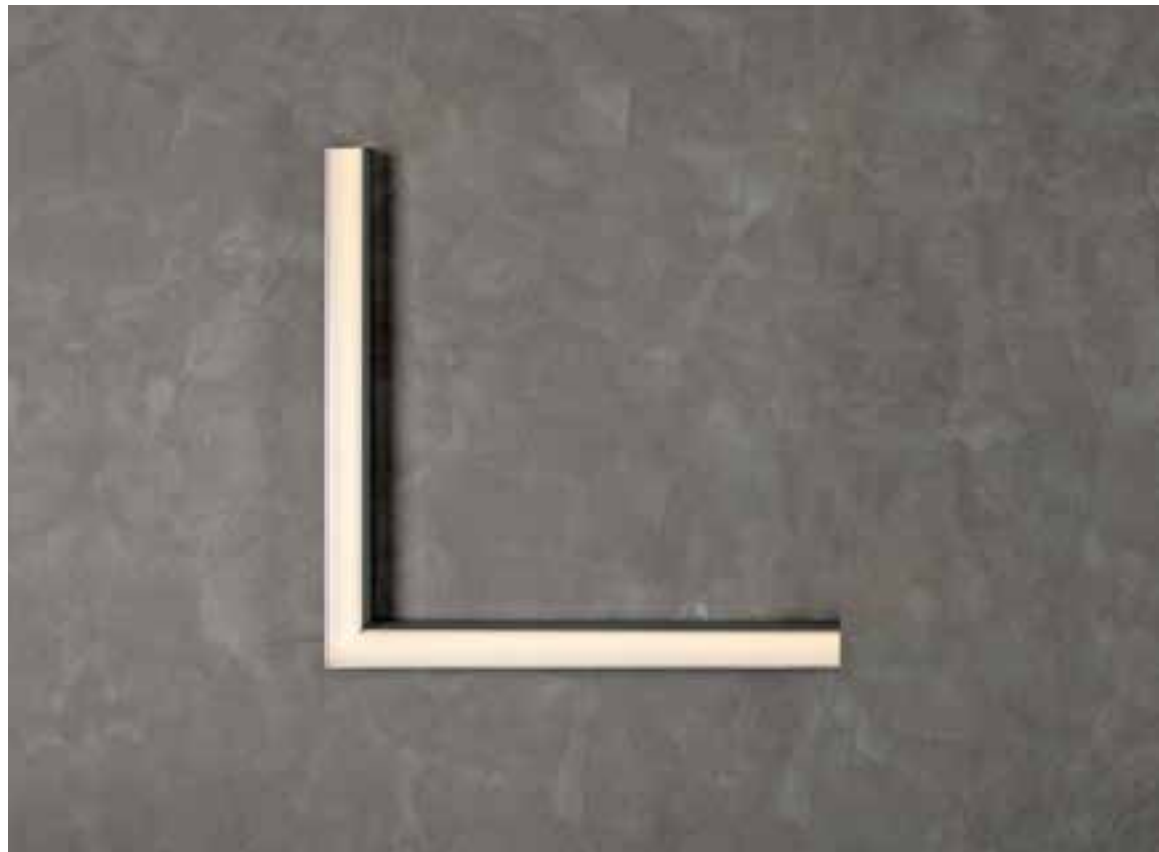



COUPLERS

Fixtures that can be used to create different combinations and shapes by combining various Hollow Shape luminaires.

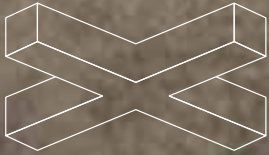
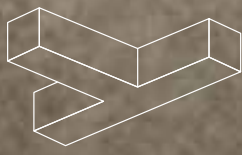
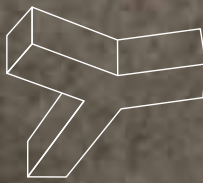
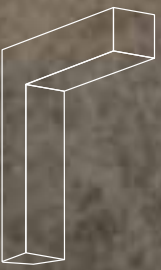
	
90° Horizontal	90° Horizontal Inside
	
X	T
	
Y Shape 120°	90° Vertical Inside

Hollow Shapes

All Hollow Shape luminaires can be mounted in four different ways, as shown here for Hexedge Hollow.

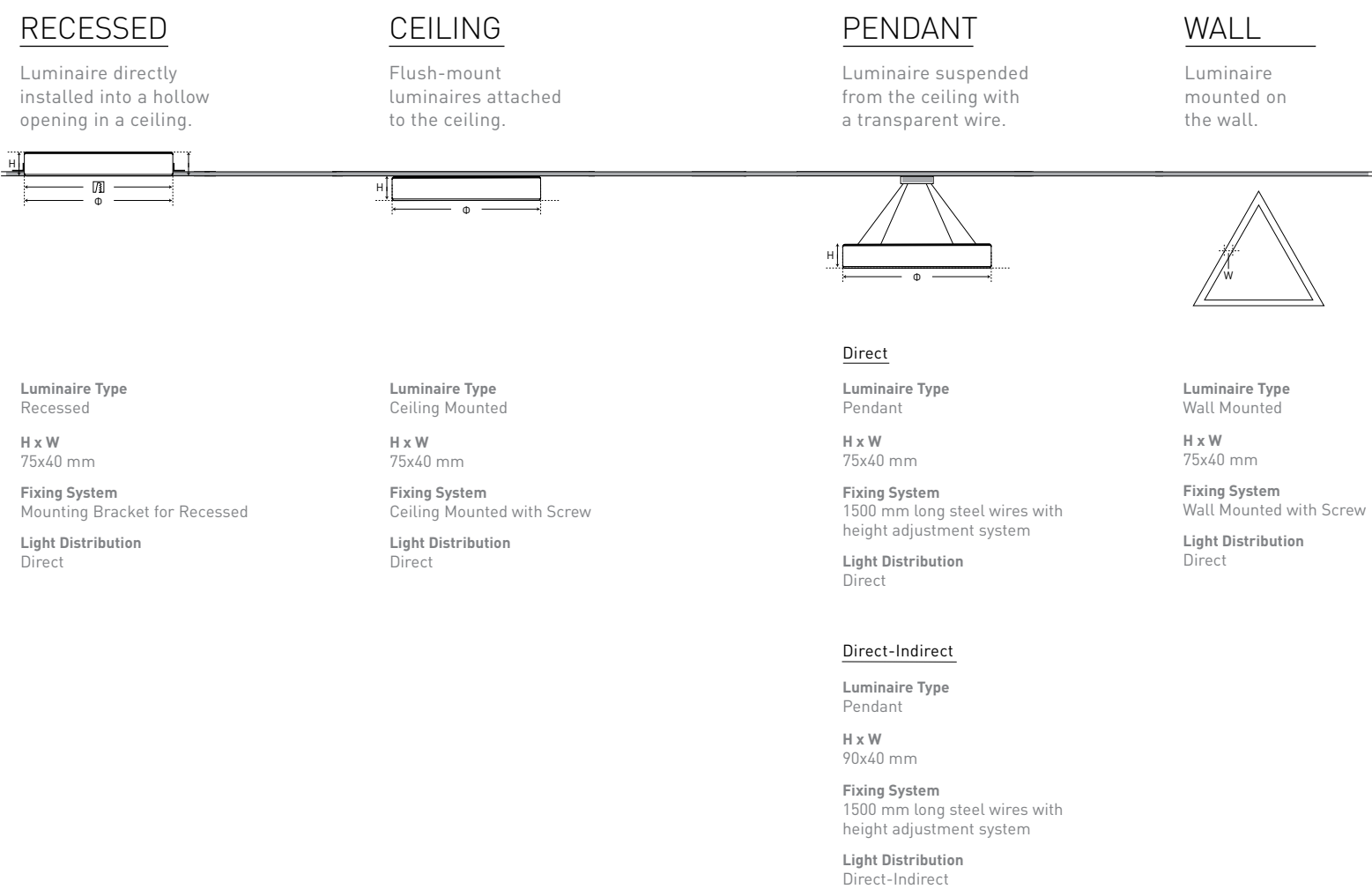

All Hollow Shapes carry the following specifications

GENERAL	Body Construction	Highest grade extruded aluminum
	Surface Finishes	Texture White Texture Black Texture Grey Any Other RAL color possible on Request
	IP Rating	40
LED	Light Source CCT	LED 3000K 4000K 5700K TW (Tunable White) 2700-6500K
	CRI	80+, 90+ (Available on request)
	MacAdam Step	3
Power Factor		0.94
Diffuser		Satin finished Opal Diffuser
Driver		Non-Dimmable DALI Dimmable 0-10V Analogue Bluetooth 4.0 CASAMBI remote control through App

All Hollow Shapes are available in the following colours

