

2

# Linear

Pure blend of  
light and form.  
Desired choice for  
adaptable, modest  
lighting solutions.

---

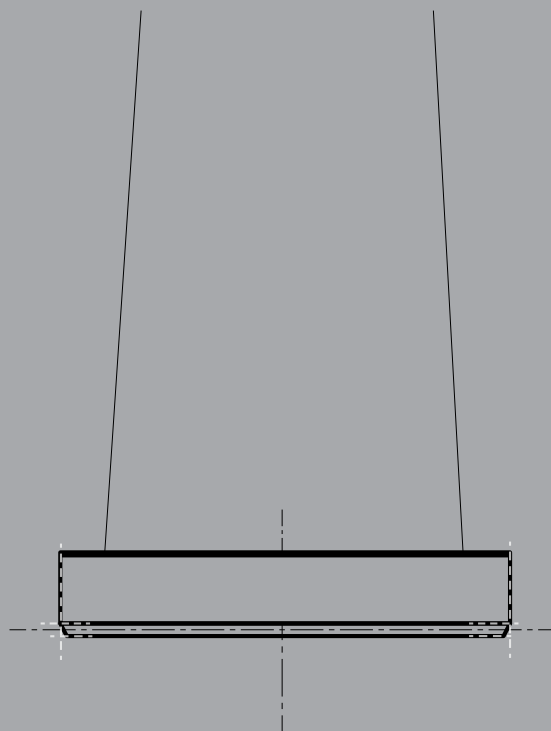

## What is Linear

LED profile for creating continuous line systems. Easily integrated into any architecture.

Produces ideal ambient lighting for any space.



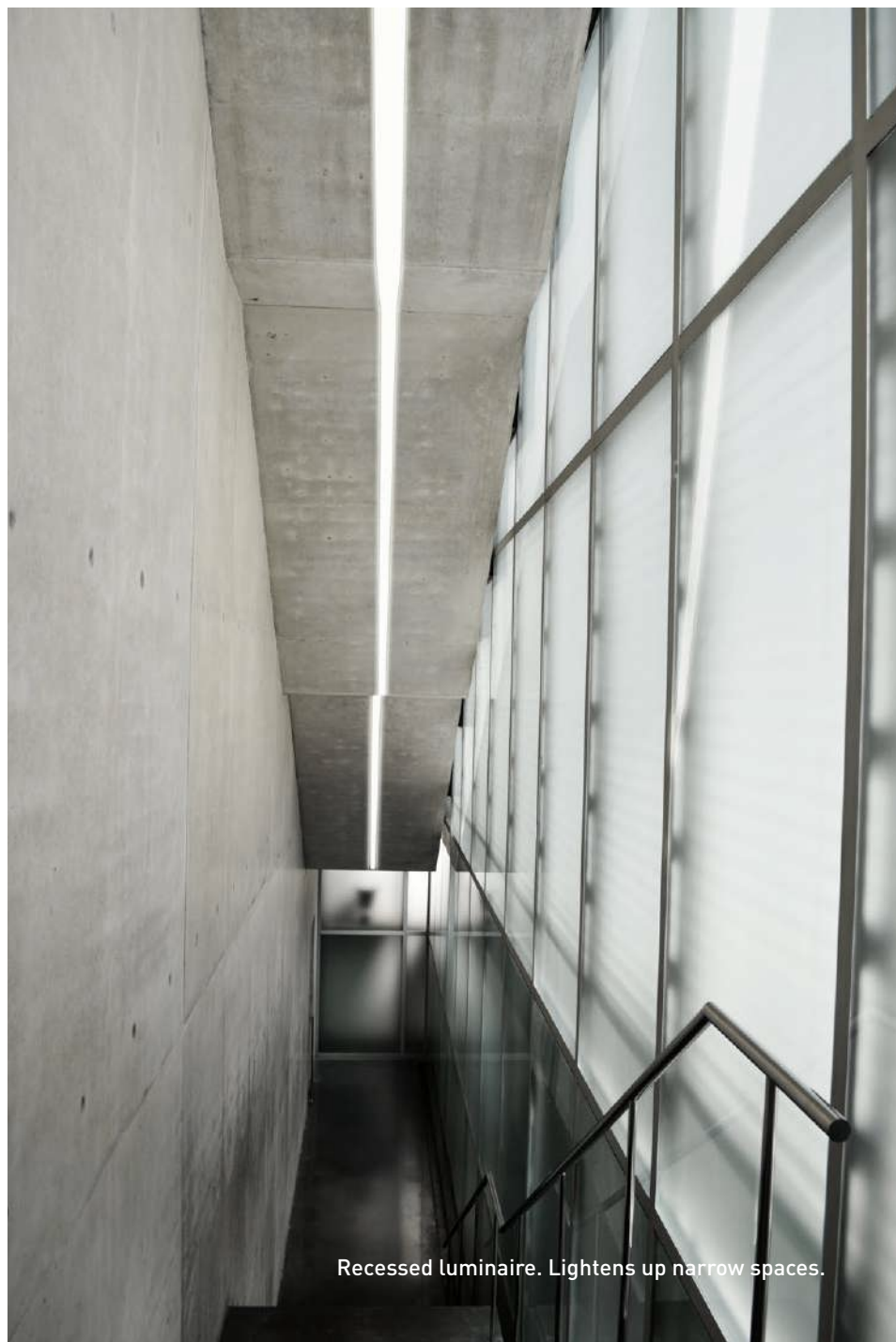

Recessed luminaire. Lightens up narrow spaces.



Linear  
with trim  
(applicable  
on 46 and 80)

Uniform  
lighting  
solution.

Even illumination creates  
**minimal distraction  
shadows** near joints  
or couplers.

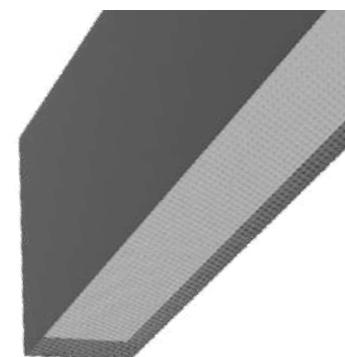

Stylishly  
adaptable  
design.

Easily customisable.  
Serves **multiple**  
interior design needs.



Aesthetic,  
functional  
luminaries.

Aesthetic. Elegant,  
optimal design, needing  
**no additional heat sink.**  
Outlasts traditional  
fluorescent tubes.

# Linear 70 family

Linear Luminaries  
with a width of 70 mm

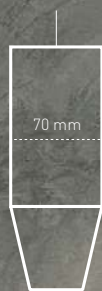

Linear 70 **Recessed**  
*without Trim*

Linear 80 **Recessed**  
*with Trim*

Linear 70 **Ceiling**

Linear 70 **Pendant**  
*Direct*

Linear 70 **Pendant**  
*Direct-Indirect*

Linear 70 **Wall**  
*Direct*

Linear 70 **Wall**  
*Direct-Indirect*

Linear with spot



Clean and simple optical system.



Combines **linear luminaries** with spotlights as per preference.

Seamlessly flexible illumination.



Creates **highlights** with spotlights and adds **diffusion** with linear lights.

Downlight, spot, linear light combination can be customised based on architectural drawings.

A journey of investigation  
and exploration

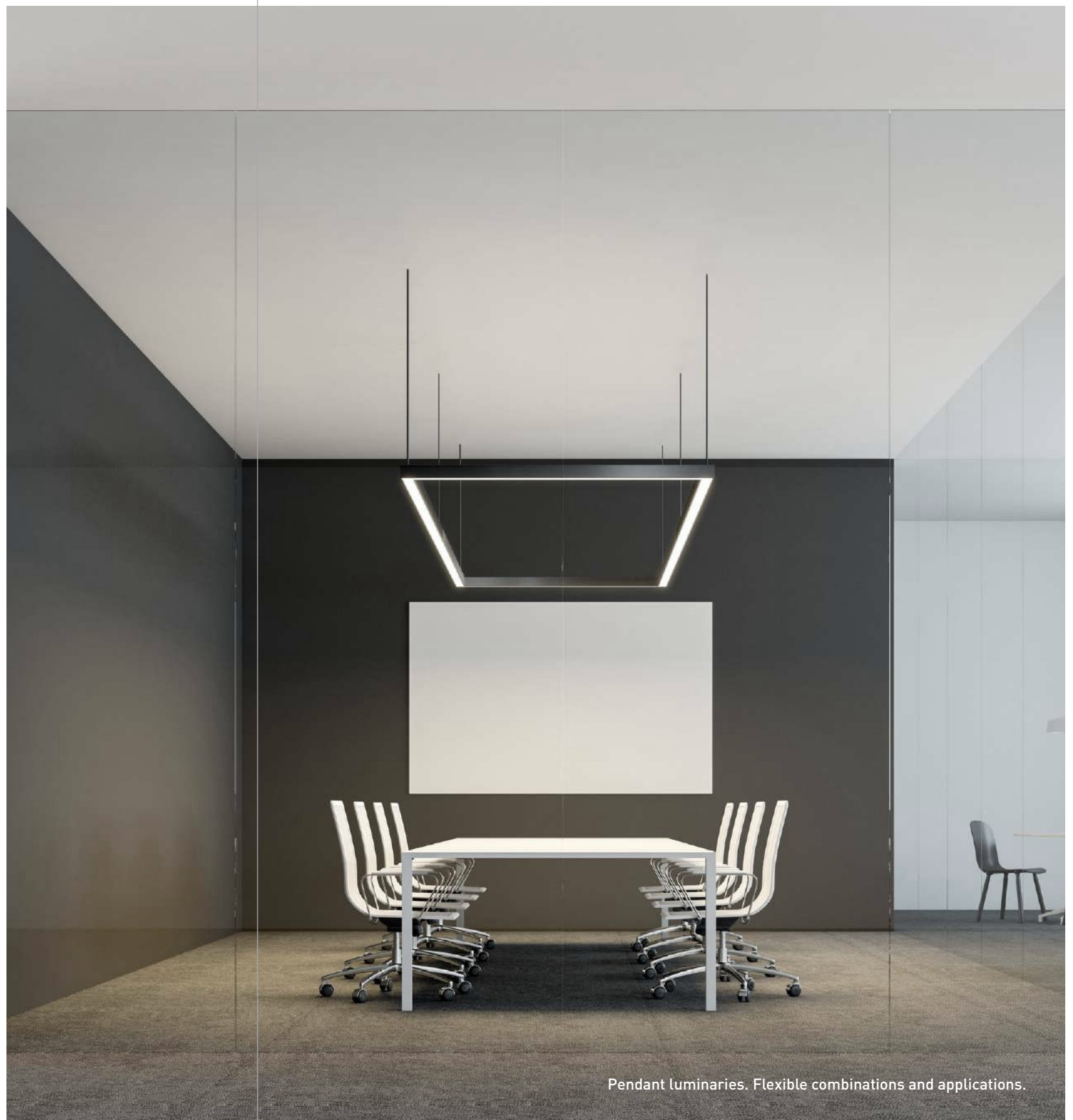

Pendant luminaires. Flexible combinations and applications.



Recessed luminaire. Continuous lighting systems for high density office spaces.

Linear 70

Linear 70

▸ Linear 80

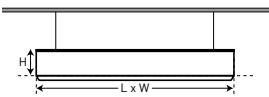

PENDANT

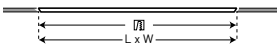

RECESSED

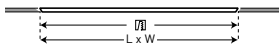

RECESSED

PENDANT

Luminaire suspended from the ceiling with a transparent wire.

DIRECT

Downward light distribution provides uniform lighting.

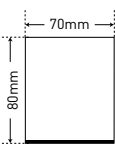

**Product Code**  
PM-70-D

**Luminaire Type**  
Pendant

**Dimension W x H x L\***  
70x80x1130 mm

**Fixing System**  
1500mm long steel wires with height adjustment system

**Couplers**  
90° Ceiling to ceiling, 90° Ceiling to Wall, T shape, 120° Y shape, X shape, 135° Angle

**Light Distribution**  
Direct

**HE (High Efficiency)**  
23W (System Wattage)

**HO (High Output)**  
27W (System Wattage)

**HE Luminous Flux**  
2047 lm at Luminaire level

**HO Luminous Flux**  
2295 lm at Luminaire level

DIRECT-INDIRECT

Provides light upward and downward. Can bring a softer ambient glow.

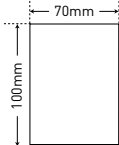

**Product Code**  
PM-70-DI

**Luminaire Type**  
Pendant

**Dimension W x H x L\***  
70x100x1130 mm

**Fixing System**  
1500mm long steel wires with height adjustment system

**Couplers**  
90° Ceiling to ceiling, 90° Ceiling to Wall, T shape, 120° Y shape, X shape, 135° Angle

**Light Distribution**  
Direct-Indirect

**HE (High Efficiency)**  
23W /11w (System Wattage)

**HO (High Output)**  
27W /13w (System Wattage)

**HE Luminous Flux**  
3026 lm at Luminaire level

**HO Luminous Flux**  
3400 lm. at Luminaire level

RECESSED

Luminaire directly installed into a hollow opening in a ceiling.

DIRECT

Downward light distribution provides uniform lighting.

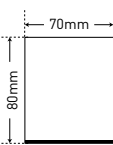

**Product Code**  
RM-70-D

**Luminaire Type**  
Recessed

**Dimension W x H x L\***  
70x80x1130 mm

**Fixing System**  
Recessed Mounting Brackets

**Couplers**  
90° Ceiling to ceiling, 90° Ceiling to Wall, T shape, 120° Y shape, X shape, 135° Angle

**Light Distribution**  
Direct

**HE (High Efficiency)**  
23W (System Wattage)

**HO (High Output)**  
27W (System Wattage)

**HE Luminous Flux**  
2047 lm at Luminaire level

**HO Luminous Flux**  
2295 lm at Luminaire level

RECESSED

Luminaire directly installed into a hollow opening in a ceiling.

DIRECT WITH TRIM

Downward light distribution provides uniform lighting.

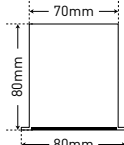

**Product Code**  
RMWT-80-D

**Luminaire Type**  
Recessed

**Dimension W x H x L\***  
80x80x1130 mm

**Fixing System**  
Recessed Mounting Brackets

**Couplers**  
90° Ceiling to ceiling, 90° Ceiling to Wall, T shape, 120° Y shape, X shape, 135° Angle

**Light Distribution**  
Direct-Indirect

**HE (High Efficiency)**  
23W (System Wattage)

**HO (High Output)**  
27W (System Wattage)

**HE Luminous Flux**  
2047 lm at Luminaire level

**HO Luminous Flux**  
2295 lm at Luminaire level

All Linear 70 carry the following specifications		
GENERAL	Body Construction	Highest grade extruded aluminum Aluminum profile single max. length available in 3380mm
	Surface Finishes	Natural anodized finish   Texture White   Texture Black   Texture Grey   Any Other RAL color possible on Request (Any Contrast color also possible)
	End Cap	Screw less End cap made of Aluminum
	LED Batten	Made of aluminum extrusion in white powder coated, is fixed in with Snap-in technique, Good for Passive Cooling.
IP Rating		
LED	Light Source CCT	LED 3000K   4000K   5700K   TW (Tunable White) 2700-6500K
	CRI	80+, 90+ (Available on request)
	UGR	<22 with Opal Diffuser, <19 with Micro-Prismatic Diffuser
	MacAdam Step	3
Power Factor		
Diffuser		
Driver		
All Linear 70 are available in the following colours		
*The length mentioned here is only for a single unit but can be changed as per your preference.		