

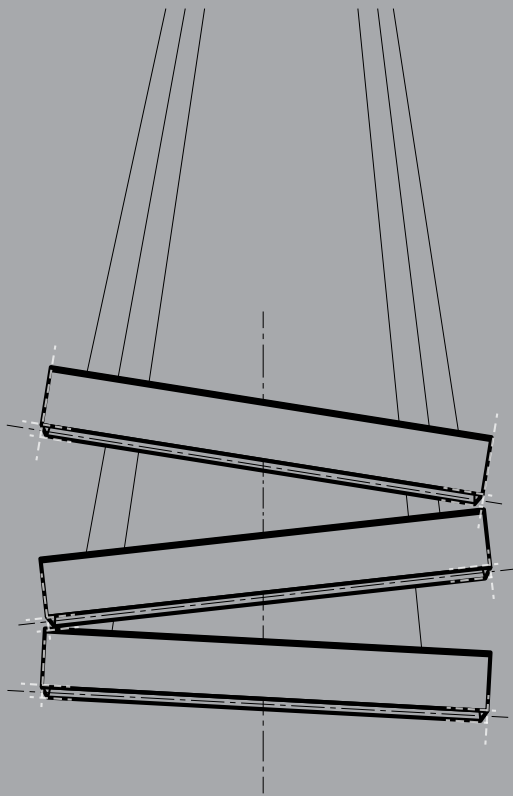

①

Groove

Highly functional
luminaire, classic and
stylish. Its minimal,
slim form can be unified
into any interior design.





Reverence for simplicity and utility

What is Groove

Glare-free luminaries that generate a fluid gradation of light.

The entire product family impresses with its typically recessed and curved aluminium profile.

Offers high visual comfort enhanced by the slender, minimalistic profile.

UGR<16



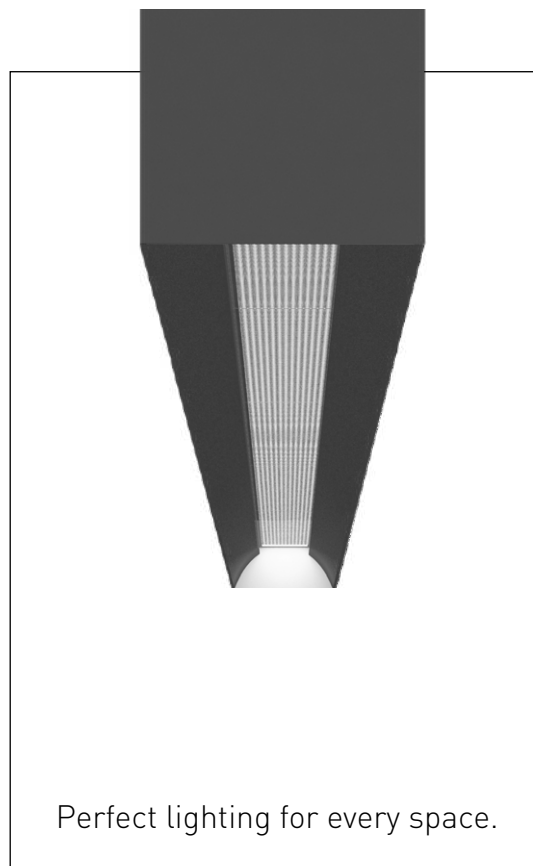

Light throw that **won't disturb glare from projectors**. Highly recommended for board rooms.

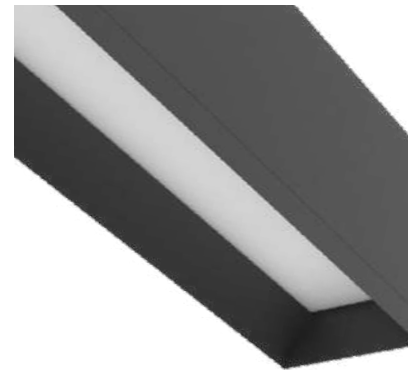

Endless design possibilities.

Regressed light source lends to a **cozy and soft light distribution**, in any atmosphere.

Optimal lighting system.

Defined light throw avoids light pilferage.



Barely there, yet impactful.

Invisible light source that provides **high visual comfort**, preventing any eye contact with it.



Recessed luminaire. Perfect for expansive spaces.



Fusion of form
with function,
bathed in luxury

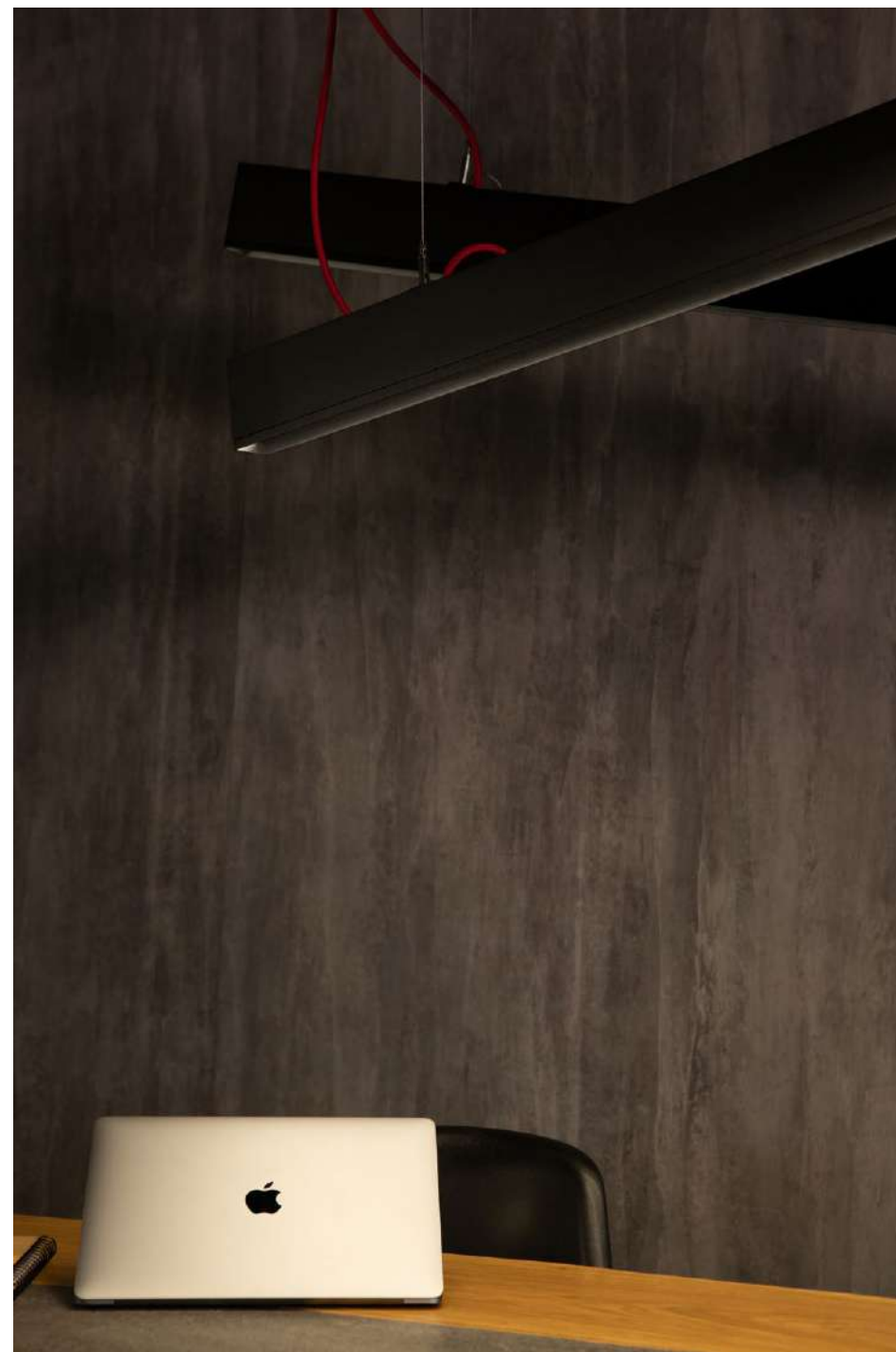



Illumination for inspiration

Groove 70

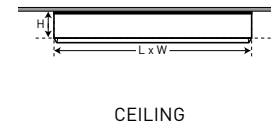
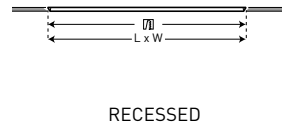
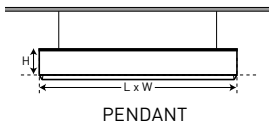

PENDANT

Luminaire suspended from the ceiling with a transparent wire.

DIRECT

Downward light distribution provides uniform lighting.

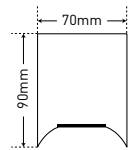

Product Code
GPM-70-D

Surface Finishes

Natural Silver anodized finish | Texture White | Texture Black | Texture Grey | Any Other RAL color possible on Request (Any Contrast color also possible)

Luminaire Type
Pendant

Dimension W x H x L*
70x90x1130 mm

Fixing System

1500mm long steel wires with height adjustment system

Couplers

90° Ceiling to ceiling, 90° Ceiling to Wall, 120° Y shape

Light Distribution
Direct

HE (High Efficiency)
23W (System Wattage)

HO (High Output)
27W (System Wattage)

HE Luminous Flux
2047 lm at Luminaire level

HO Luminous Flux
2295 lm at Luminaire level

DIRECT-INDIRECT

Provides light upward and downward. Can bring a softer ambient glow.

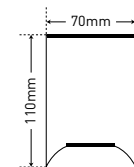

Product Code
GPM-70-DI

Surface Finishes

Natural Silver anodized finish | Texture White | Texture Black | Texture Grey | Any Other RAL color possible on Request (Any Contrast color also possible)

Luminaire Type
Pendant

Dimension W x H x L*
70x110x1130 mm

Fixing System

1500mm long steel wires with height adjustment system

Couplers

90° Ceiling to ceiling, 90° Ceiling to Wall, 120° Y shape, X shape, 135° Angle

Light Distribution
Direct-Indirect

HE (High Efficiency)
23W /11w (System Wattage)

HO (High Output)
27W /13w (System Wattage)

HE Luminous Flux
3026 lm at Luminaire level

HO Luminous Flux
3400 lm. at Luminaire level

RECESSED

Luminaire directly installed into a hollow opening in a ceiling.

DIRECT WITH TRIM

Downward light distribution provides uniform lighting.

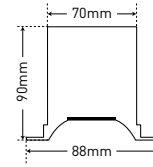

Product Code
GRT-88-D

Surface Finishes

Natural Silver anodized finish | Texture White | Texture Black | Texture Grey | Any Other RAL color possible on Request (Any Contrast color also possible)

Luminaire Type
Recessed

Dimension W x H x L*
88x90x1130 mm

Fixing System

Recessed Mounting Brackets

Couplers

90° Ceiling to ceiling, 90° Ceiling to Wall, 120° Y shape

Light Distribution
Direct

HE (High Efficiency)
23W (System Wattage)

HO (High Output)
27W (System Wattage)

HE Luminous Flux
2047 lm at Luminaire level

HO Luminous Flux
2295 lm at Luminaire level

CEILING

Flush-mount luminaries attached to the ceiling.

DIRECT

Downward light distribution provides uniform lighting.

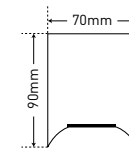

Product Code
GCM-70-D

Surface Finishes

Natural Silver anodized finish | Texture White | Texture Black | Texture Grey | Any Other RAL color possible on Request

Luminaire Type
Ceiling Mounted

Dimension W x H x L*
70x90x1130 mm

Fixing System

Surface Mount with Screw

Couplers

90° Ceiling to ceiling, 90° Ceiling to Wall, 120° Y shape

Light Distribution
Direct

HE (High Efficiency)
23W (System Wattage)

HO (High Output)
27W (System Wattage)

HE Luminous Flux
2047 lm at Luminaire level

HO Luminous Flux
2295 lm at Luminaire level

All Groove 70 carry the following specifications

GENERAL	Body Construction	Highest grade extruded aluminum Aluminum profile single max. length available in 3380mm
	End Cap	Screw less End cap made of Aluminum
	LED Batten	Made of aluminum extrusion in white powder coated, is fixed in with Snap-in technique
	IP Rating	40

LED	Light Source CCT	LED 3000K 4000K 5700K TW (Tunable White) 2700-6500K
	CRI	80+, 90+ (Available on request)
	UGR MacAdam Step	<16 3

Power Factor 0.94
Push-in Wago terminals for quick and easy wiring between two led modules Quick coupling BJB Connector to simplify connections between the subsequent modules.

Diffuser	Satin finished PC Opal Diffuser or Micro-Prismatic diffuser , is fixed with Snap-in technique, Diffuser single max. length available in 3380mm
-----------------	---

Driver	Non-Dimmable DALI Dimmable 0-10V Analogue Dimmable Bluetooth 4.0 CASAMBI remote control through App
---------------	---

All Groove 70 are available in the following colours



*The length mentioned here is only for a single unit but can be changed as per your preference.